

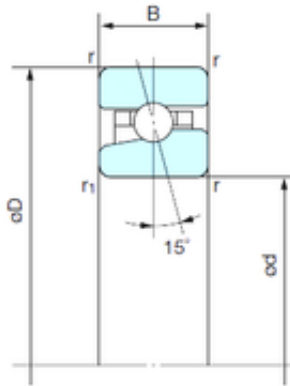

DRIVESHAFT AND BEARINGS MANUFACTURE C...

50 mm x 80 mm x 16 mm NACHI BNH 010
angular contact ball bearings



Bearing No. BNH 010

Size	50x80x16 mm
Bore Diameter	50 mm
Outer Diameter	80 mm
Width	16 mm
d	50 mm
D	80 mm
B	16 mm
C	16 mm
Angle (°)	15 °
r min.	1 mm
r1 min.	0.6 mm
Basic dynamic load rating (C)	16,1 kN
Basic static load rating (C0)	15,9 kN
(Grease) Lubrication Speed	19000 r/min

BNH 010 Bearing 2D drawings and 3D CAD models