

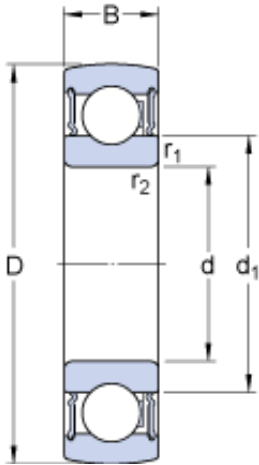

DRIVESHAFT AND BEARINGS MANUFACTURE C...



60 mm x 110 mm x 22 mm SKF 1726212-2RS1
deep groove ball bearings

Bearing No. 1726212-2RS1

1726212-2RS1 Bearing 2D drawings and 3D CAD models

Size	110x60x22 mm
Bore Diameter	110 mm
Outer Diameter	60 mm
Width	22 mm
d	60 mm
D	110 mm
B	22 mm
d ₁	75.5 mm
r _{1,2} - min.	1.5 mm
Basic dynamic load rating - C	52.7 kN
Basic static load rating - C ₀	36 kN
Fatigue load limit - P _u	1.5 kN
Limiting speed	4000 r/min
Calculation factor - f ₀	14
Category	Insert Bearings Spherical OD
Inventory	0.0
Manufacturer Name	SKF
Minimum Buy Quantity	N/A
Weight / Kilogram	0.75
EAN	7316570435030
Product Group	M06110
Inner Race Profile	Standard Inner Ring
Outer Race Profile	Spherical



DRIVESHAFT AND BEARINGS MANUFACTURE C...

Relubricatable	No
Seal Type	RS1 Seal
Mounting Method	Shaft Mount
Rolling Element	Ball Bearing
Snap Ring	No
Long Description	60MM Bore; Standard Inner Ring; Ball Bearing; 22MM Length Thru Bore; 22MM Outer Race Width; 110MM Outside Diameter; Not Relubricatable; RS1 Seal Seal; Shaft Mount Mounting Method; No Snap Ring
Inch - Metric	Metric
Other Features	Single Row Standard Duty Metric
Category	Insert Bearings
UNSPSC	31171536
Harmonized Tariff Code	8482.10.50.00
Noun	Bearing
Keyword String	Insert
Manufacturer URL	http://www.skf.com
Manufacturer Item Number	1726212-2RS1
Weight / LBS	1.65
Bore	2.362 Inch 60 Millimeter
Outside Diameter	4.331 Inch 110 Millimeter
Length Thru Bore	0.866 Inch 22 Millimeter
Outer Race Width	0.866 Inch 22 Millimeter
bore diameter:	60 mm
radial static load capacity:	36 kN
outside diameter:	110 mm
finish/coating:	Uncoated
outer ring width:	22 mm
maximum rpm:	4000 RPM
bore type:	Round



DRIVESHAFT AND BEARINGS MANUFACTURE C...

seal type:	Contact/Lip
operating temperature range:	-40 to +210 ° F
series:	17262
radial dynamic load capacity:	52.7 kN
d_1	75.5 mm
$r_{1,2}$ min.	1.5 mm
Basic dynamic load rating C	52.7 kN
Basic static load rating C_0	36 kN
Fatigue load limit P_u	1.53 kN
Limiting speed ¹⁾	4000 r/min
Calculation factor f_0	14
Mass complete bearing	0.77 kg